

Outline Drawing

客户确认签名
Customer approved

日期
Date

VER	REVISION RECORD	Date	Name
A	NEW RELEASE	2018/06/16	YGH
B			
C			

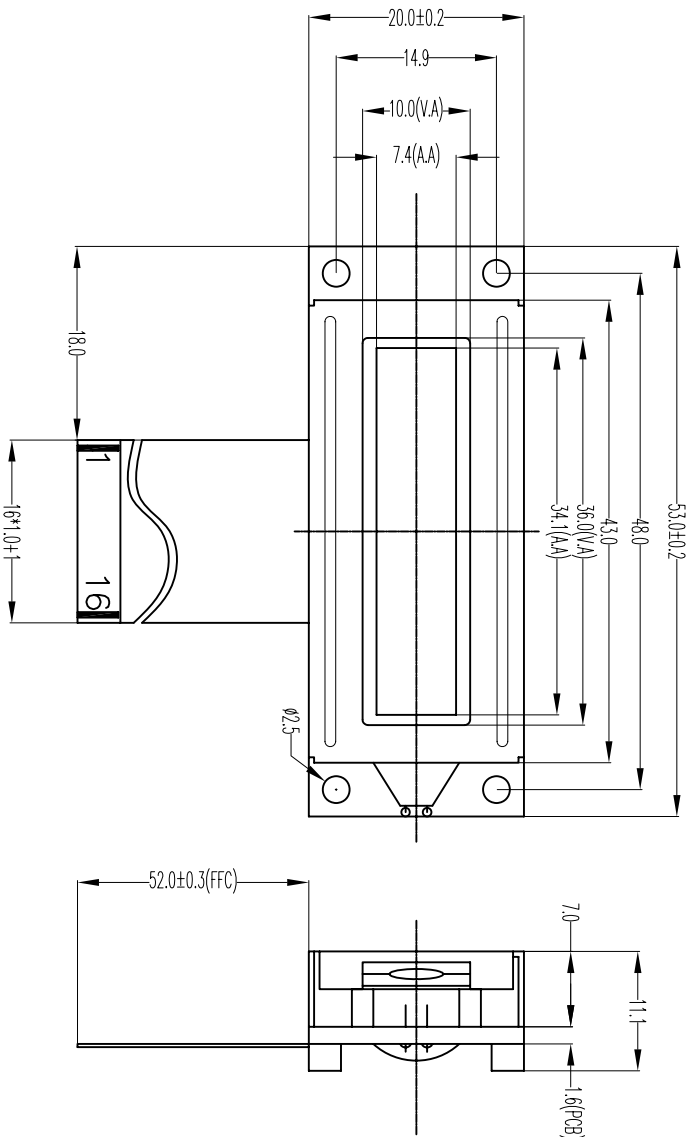

PIN	SYMBOL
1	VSS
2	VDD
3	V0
4	RS
5	R/W
6	E
7	D0
8	D1
9	D2
10	D3
11	D4
12	D5
13	D6
14	D7
15	LEDA
16	LEDK

NOTE

- 1.Lcd Display Type: FSTN
- 2.Polarzier Mode: Transflective, Positive
- 3.Viewing Direction: 6:00
- 4.Drive Method: 1/5Bias, 1/16Duty
- 5.Logic Supply Voltage: 5.0V
- 6.LCD Driving Voltage: 4.8V
- 7.Operating Temp: -20 TO 70°C
- 8.Storage Temp: -30 TO 80°C
- 9.Control IC: UC17066-01(E/J FONT, COB)
- 10.Backlight: White, Vled=3.3V
- 11.Connector:
- 12.Ulteriorly Tolerance: ±0.2MM



深圳市隼目显示技术有限公司
Shenzhen Eagle Vision Display Technology Co., Ltd

LCM TYPE
16*2 CHARACTERS

Material No.

Dwg: CUSTOMER

Check: MODULE LMC16260FWWT-01A

SCALE: 1:1

Visual Angle



SHEET 1 OF 1